



# HY-5082A Massage chair

Operation Instructions



Please keep this operation instructions properly

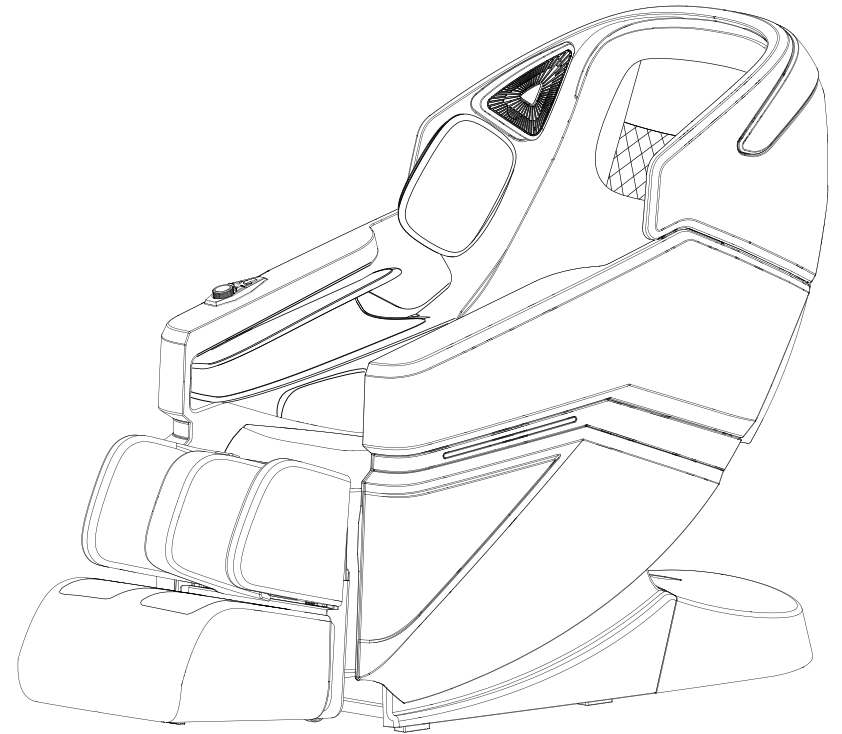

Thanks for choosing our products, please read this manual carefully before using, so as to know the right way to use it. Please pay attention to the important warnings, and keep this manual properly.

Remark: our company keeps the right to change and explain the product design, we will not announce if there is change, product real color shall prevail.

## **Contents**

---

<b>Safety and maintenance</b>	02-03
<b>Warnings</b>	04-05
<b>Parts</b>	06
<b>Functions</b>	07
<b>Remote control instruction</b>	08-09
<b>Usage methods</b>	10-21
<b>Power on</b>	10
<b>Massage function control operation</b>	10-17
<b>Voice control operation</b>	18
<b>Fast control button</b>	19
<b>Turn off and stop massage</b>	20
<b>Method to move the product</b>	20
<b>Specification</b>	21
<b>Maintenance and cleaning of product</b>	21

## Safety and maintenance

---

### 1. Important warning

- Keep children away from the moving parts of this product.
- Please use well-grounding power matching this product.
- Please pull off the power cord after using or before cleaning, to avoid damage or injury.
- Please use this product according to the instructions.
- Please don't use unrecommended accessories.
- Please don't use this product outside .
- Please read this manual carefully before using.
- Do not use this product for purpose which are not listed in this manual.
- Recommended using time is no more than 30 minutes.
- Please don't use if the covers are broken.
- Please don't use if the ventilation holes are blocked.
- Please don't drop any objects into this product.
- Please don't fall asleep when using this product.
- Please don't use this product under drunk or unwell situation.
- Please don't use this product in one hour after having meal.
- Please don't push hard when using this product to avoid injury.

### 2. Environment

- Please don't use under high temperature and humidity circumstance such as bathroom.
- Please don't use when environment temperature changes dramatically.
- Please don't use under environments where dusts are heavy or full of corrosive air.
- Please don't use where space is limited or air circulation is not smooth.

### 3. Users not suitable to use massage chair

- Users with malignant tumor, osteoporosis, and spine broken.
- Users with heart disease or equipped with electronic medical devices such as pacemaker.
- Users with high fever, or wounded just after surgical operation.
- Pregnant, puerperants or menstrual women.
- Users with surface or internal injuries.
- Users under 14-year old without adult's supervision, or unwell minded are not allowed to use this product.
- Users who need to take rests according to doctors' or not feeling well.
- Users in wet body are not allowed to use this product.
- Users who are sensitive to heating must pay attention during usage.

## Safety and maintenance

---

### 4. Safety notice

- Check if the voltage complies to this product's specification.
- Don't plug in and out the power cord with wet hands.
- Prevent this product from water so as to cause electric shock or damage.
- Don't put strength on the power cord when plugging in and out.
- Don't damage the wires or change its circuit.
- Don't clean the live parts with wet cloth, such as power switch and plug.
- Please leave this product when power is cut off, to avoid injury if power supply comes back.
- When users find this product abnormal during usage, please stop using immediately and consult local distributors.
- When users feel unwell during usage, please stop using immediately and consult a doctor.
- This product does not suit users with physical disability, nerve imperfection or those lack of experience and common knowledge (including children), unless they are guided or supervised by their guardian.

### 5. Maintenance

- This product must be maintained in authorized service center, users are not allowed to disassemble it and repair.
- Please shut off the power switch after usage.
- Don't use this product when power socket is loose.
- Scroll the power cord and put this product in dry environment if it will not be used for long time.
- Don't put this product close to high temperature, fire, and direct sunshine.
- Please clean with dry cloth, no diluent, benzene and alcohol.
- The mechanical parts of this product is specially designed and manufactured, no need special maintenance.
- Don't use sharp objects toward this product.
- Don't move this product on unsmooth ground, labor lift is required.
- Don't use this product continuously.

### 6. Common phenomenon settles down

- Motor noise during usage is normal.
- Remote control doesn't work: check if power cord and power socket is connected well; check if power switch is turned on.
- This product stop working: it stops automatically when rated working time is out; it works continuously long time so that the temperature protection switches on and shut off automatically, use it after half an hour.

## Warnings

### ⚠ Warnings

Don't push down towards the calfrest when it goes up, to avoid the massage chair leaning forward and cause damages and injuries

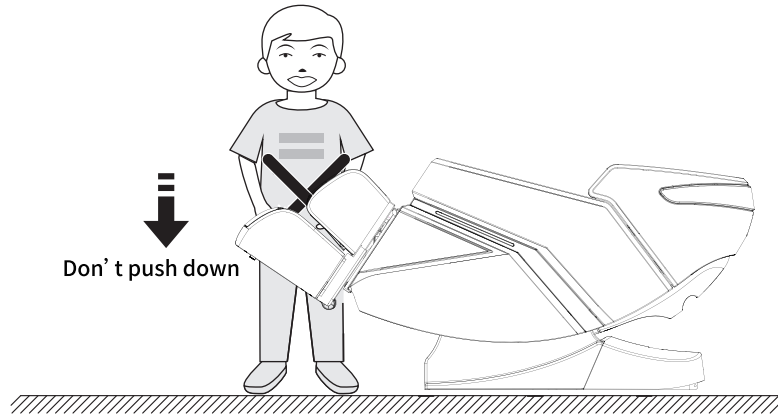

### ⚠ Warnings

Make sure that the massage hands are not in seat position before sitting on it, to avoid uncomfortable or damage to massage hands

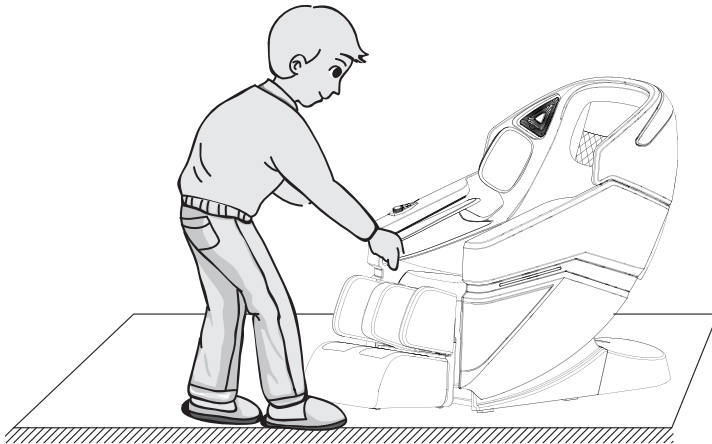

04

## Warnings

### ⚠ Warnings

Under standby and power on situation, don't pull the remote wire or power cord to avoid damage or sudden electric shock; scrolling the remote wire and power cord is recommended

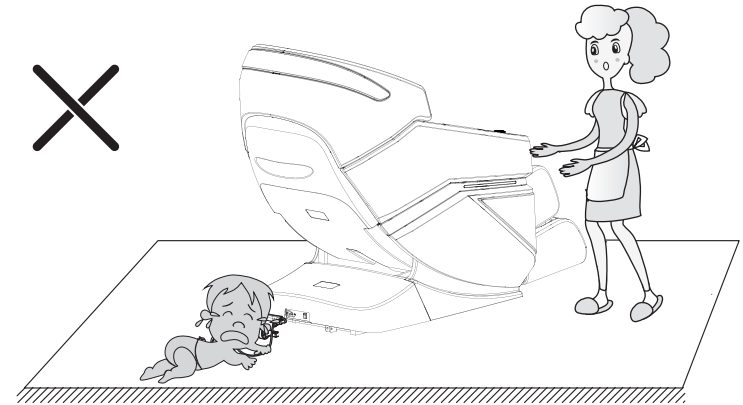

### ⚠ Warnings

Make sure that no pets and children are under the footrest and backrest before operating zero gravity function, to avoid damages and injuries

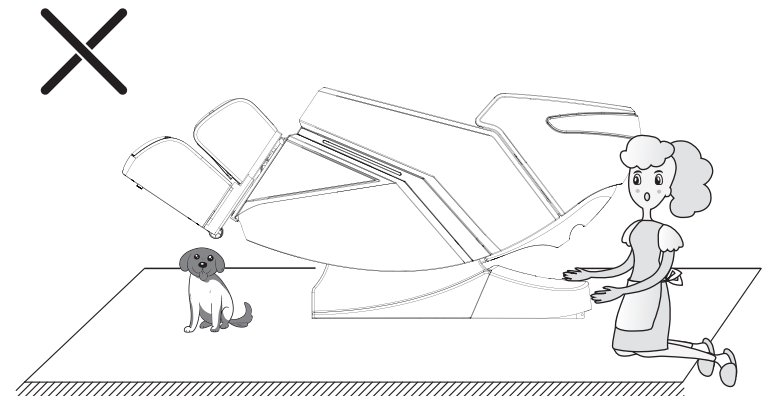

05

## Parts

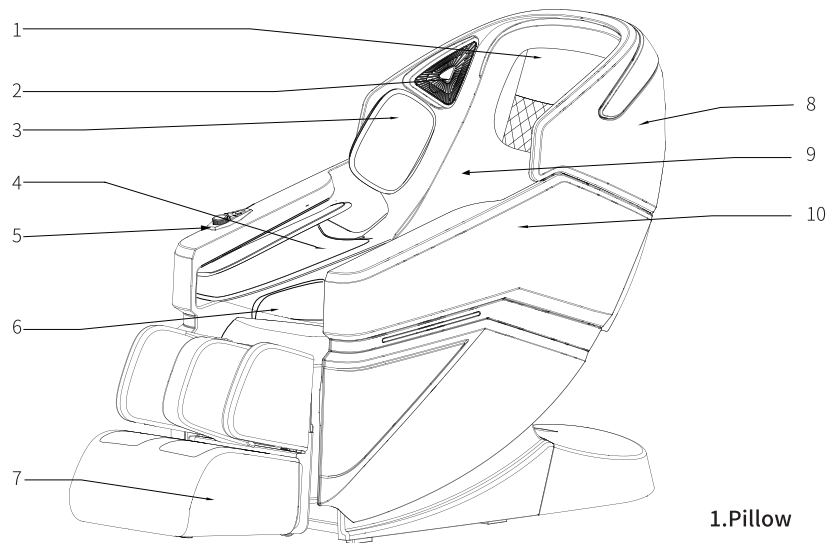

- 1.Pillow
- 2.3D digital audio
- 3.Upper arm airbags
- 4.Arm airbags
- 5.Fast control button
- 6.Side airbag
- 7.Calfrest
- 8.Space capsule
- 9.Backrest cushion
- 10.Armrest

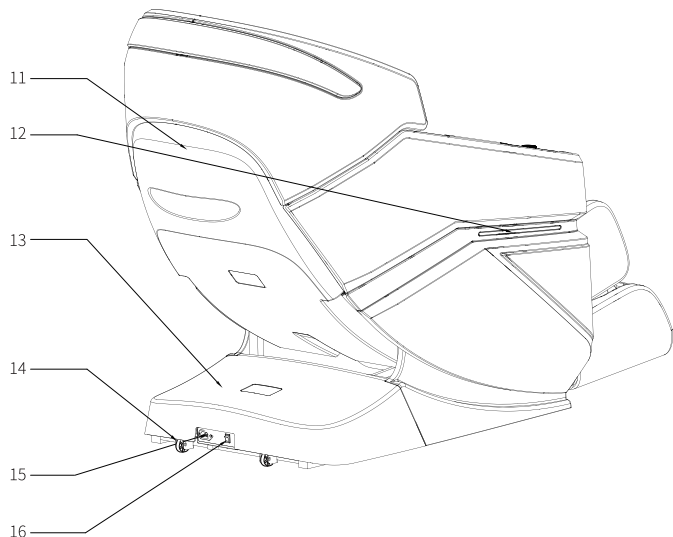

## Functions

- This product is designed with intelligent muted massage hands which can move up and down, can offer knead and flap functions.
- It is designed with shoulder position automatic detection and adjustment, it can automatically calculate acupuncture points according to different shoulder heights, so as to offer humanistic and scientific massage.
- It is designed with 12 automatic modes: master's choice, easy sleep, health recharge, Pain relief, full body stretch, neck&shoulder, waist care, hip shaping, fatigue recover, lady mode, worker mode, cybraian mode.
- It is designed with 3 memory modes.
- Manual modes: available options for massage position, massage mode, massage speed, width.
- Airbag massage: full body airbag, upper body airbag, lower body airbag with 3 strength options.
- It is designed with waist leg heating function: adopts graphene as far-infrared source, to accelerate blood circulation and prevent waist leg muscle strain.
- The reclining of backrest adopts combination of cylinder and rail technology, which enables maximum space-saving.
- The backrest rail uses SL curved rail technology, to matches the backrest shape perfectly and offers close massage from head to thigh.
- Wireless Bluetooth music: designed with 3D digital audio in left and right upper armrests, helps users releasing stress by listening music while enjoying massage.
- It is designed with voice control function: the detector is built inside the left side speaker, enjoy the massage at your own will by just making simple commands.
- It is designed with sole roller and calf kneading massage.
- It is designed with calfrest and backrest recline and decline function.
- It is designed with LED lights on both left and right armrests.
- It is designed with 3.5 inches TFT colorful remote control.
- It is designed with calfrest swing stretch function that is patented technology.

## Remote control instructions

### Remote control screen

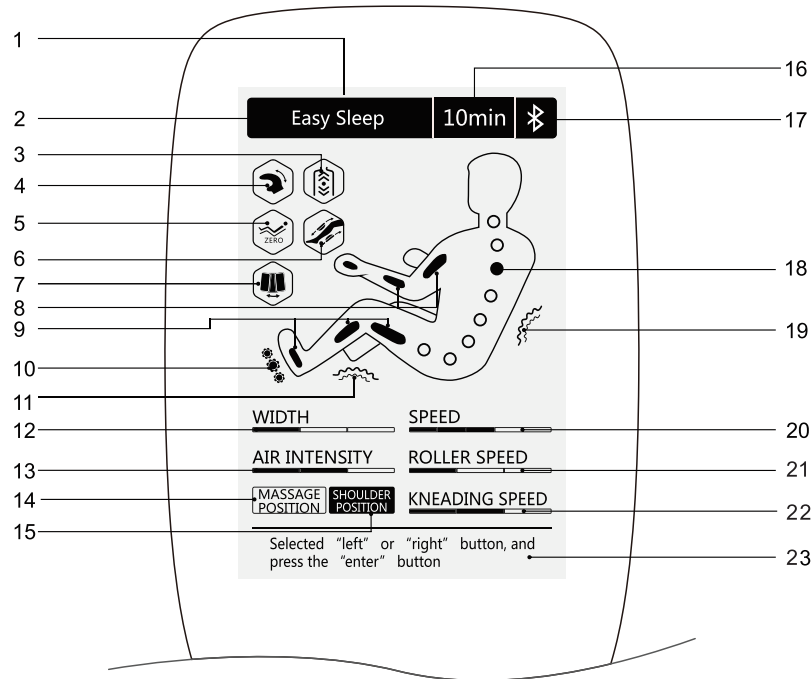

**Note: the colors shown in screen, typesetting and order of massage functions and their icons should prevail to real screen!**

- |                                |                                       |
|--------------------------------|---------------------------------------|
| 1.TFT colorful LCD             | 13.Airbag strength adjustment         |
| 2.Massage function display     | 14.Massage position adjustment        |
| 3.Backrest stretch display     | 15.Shoulder position adjustment       |
| 4.Massage method display       | 16.Timing                             |
| 5.Zero gravity display         | 17.Bluetooth                          |
| 6.Calfrest kneading display    | 18.Massage position display           |
| 7.Leg swing display            | 19.Backrest heating display           |
| 8.Armrest airbag display       | 20.Speed adjustment                   |
| 9.Thigh and leg airbag display | 21.Roller speed adjustment            |
| 10.Sole roller display         | 22.Calfrest kneading speed adjustment |
| 11.Leg heating display         | 23.Info                               |
| 12.Width adjustment            |                                       |

## Remote control instructions

### Remote buttons

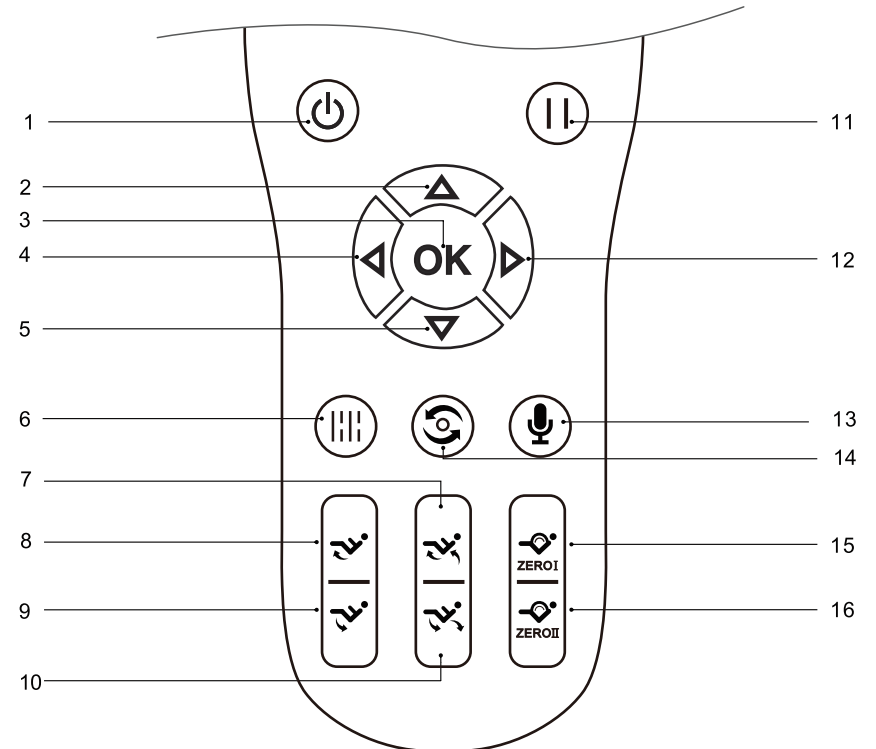

- |   |   |
|---|---|
| 1.on/off: start or stop massage chair     | 10.Lay-down: massage chair lays down                |
| 2.Up: to move up the navigation button    | 11.Pause: stop current functions                    |
| 3.Ok: confirm                             | 12.Right: right navigation button                   |
| 4.Left: left control                      | 13.Voice control:voice control button               |
| 5.Down: down control                      | 14.Auto:to enter automatic modes                    |
| 6.Home: enter main interface              | 15.Zero gravity: adjust the angle to zero gravity 1 |
| 7.Sit up: massage chair sits up           | 16.Zero gravity: adjust the angle to zero gravity 2 |
| 8.Calfrest recline: lift up the calfrest  |   |
| 9.Calfrest decline: lay down the calfrest |   |

## Usage methods

### I、Switch on

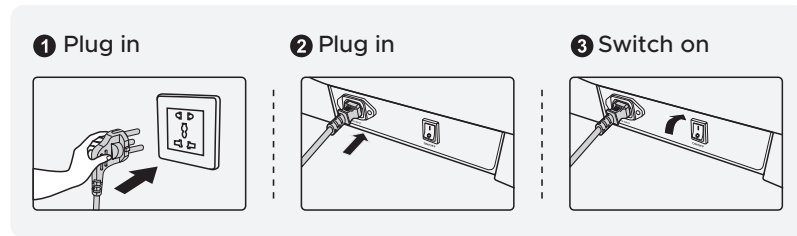

### II、Message function operation

#### 1. Standby

Message chair is under standby position.

Screen display: Enjoy the Healthy life

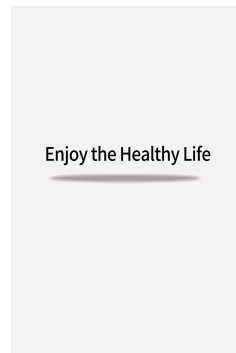

#### 2. Start massage (on/off)

· Press on/off button to start massage

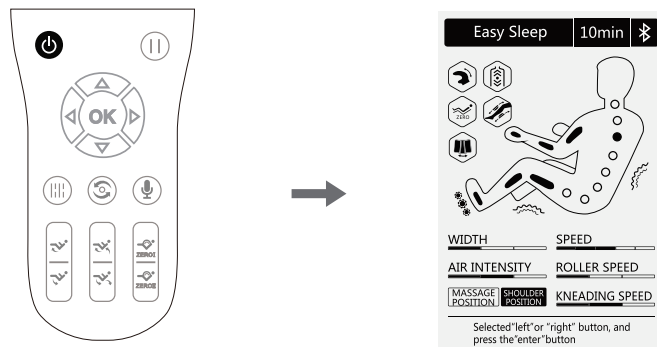

## Usage methods

### 1). Automatic lay-down adjustment

· After starting the massage, the chair will enter automatic lay-down position and detect shoulder position.

Display screen:

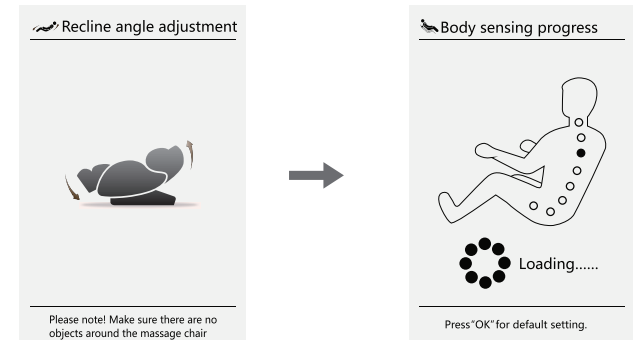

### 2). shoulder position detect and adjustment

· When massage hands detect the shoulder position, buzzer sounds “Didi”, adjust it by pushing “up” or “down” if it is not the real position, there are 11 level options. It will enter massage mode if there is no adjustment within 10 seconds. It can also enter massage mode by pressing “OK” button. If shoulder position can't be detected, the massage will run according to default shoulder height.

Display screen:

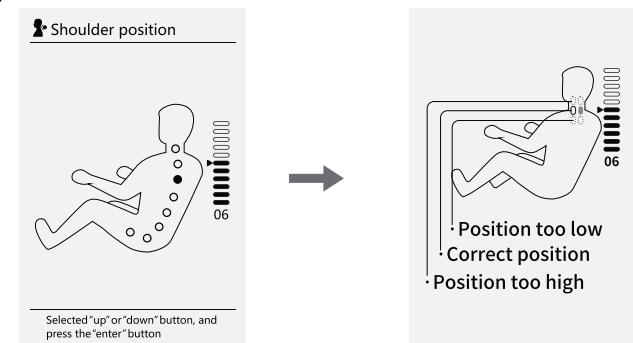

Button	Description
	Move up the roller to suitable position.
	Move down the roller to suitable position.

## Usage methods

- If shoulder position needs to be adjusted after starting massage, it can be done by pressing navigation button 'Left' or 'Right' to enter the shoulder position interface, then press 'Up' or 'down' button to adjust the shoulder position. Display screen:

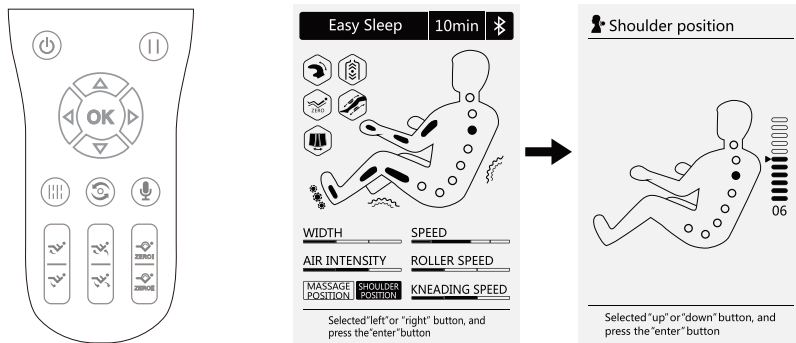

### 3)、Massage position adjustment

- If massage position needs to be changed after massage is turning on and the current mode is in fixed or partial status under manual mode, it can be done by pressing navigation button 'Left' or 'Right' to enter the massage position interface. Press 'Up' button and don't lose to move the massage hands upward, it stops when finger loses; press 'Down' button and don't lose to move the massage hands downward, it stops when fingers loses. Display screen:

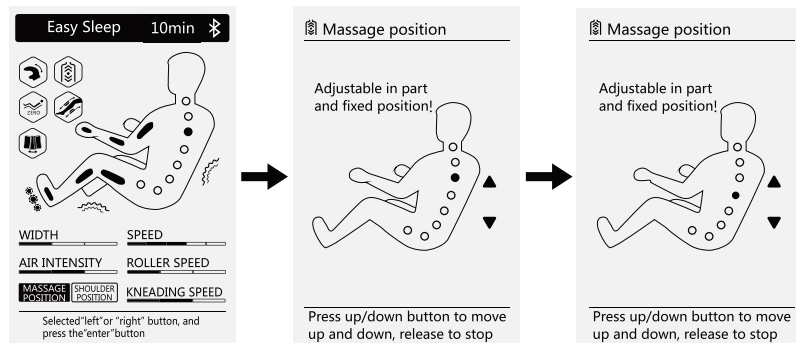

## Usage methods

### 3. Pause

- When massage is in process, stop current massage functions by pressing 'Pause' button, press it again to continue. If pause period is more than 20 minutes, all massage functions will be turned off automatically.

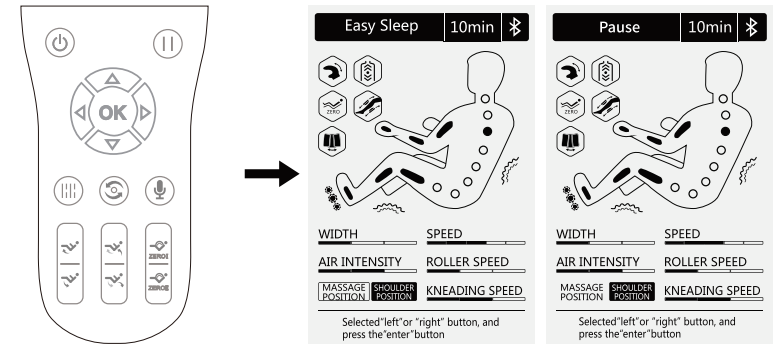

Massage functions in process    Massage functions pause

### 4. Menu

- Enter main interface by pressing 'Menu' button, it contains auto program, manual program, airbag massage, additional function, memory storage, setting...etc. To select by pressing 'Up' or 'Down' button, return to previous menu by pressing 'Left' button, enter next menu by pressing 'Right' button, confirm by pressing 'OK' button.

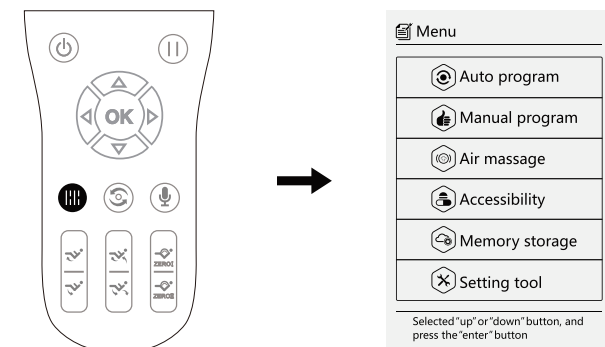

## Usage methods

### 5. Auto program (Menu-auto program, can also enter auto program interface by pressing 'Auto' button)

- Enter menu interface by pressing 'Menu' button, choose auto program icon, there are 12 automatic modes: master's choice, easy sleep, health recharge, pain relief, full body stretch, neck and shoulder, waistcare, hip shaping, fatigue recovery, lady mode, worker mode, cybraian Mode.

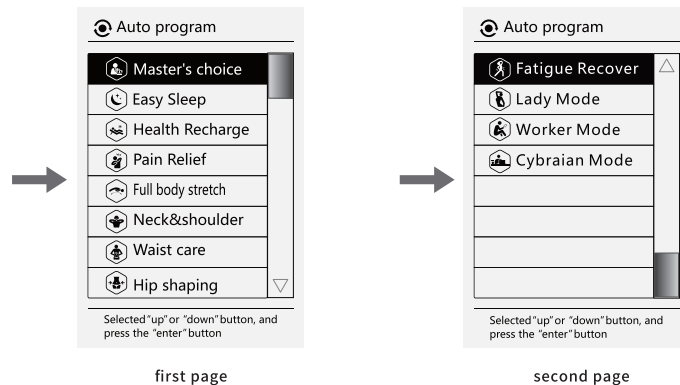
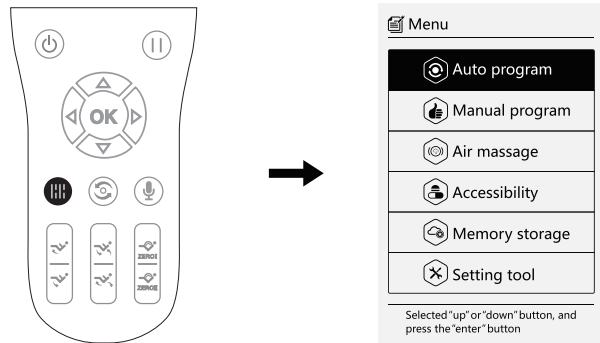

## Usage methods

### 6. Manual program

- Enter menu interface by pressing 'Menu' button, choose manual program icon including methods, area, speed, width...etc.
- There are 9 massage methods: 360°knead, clockwise knead, counter-clockwise knead, upper knead, lower knead, tap, knead&tap, knock and shiatsu.
- There are 5 areas: full back, upper back, lower back, partial and fixed position.
- There are 5 speed options. Speed can only be adjusted under manual modes.
- There are 3 width options. Width can only be adjusted in flapping, knocking and shiatsu status under manual mode.

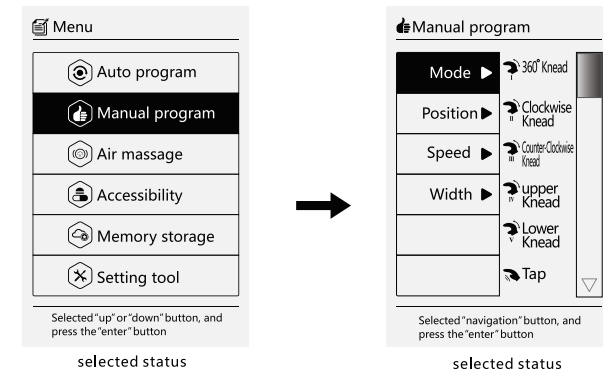

- Note: To select by pressing 'up' or 'down' button, return to previous menu by pressing 'Left' button, enter next menu by pressing 'Right' button, confirm by pressing 'OK' button. These operations are same under other interfaces.

## Usage methods

### 7. Airbag massage

- Enter home by pressing 'Menu' button, choose airbag massage: full body, upper body, lower body. There are 3 strength levels.

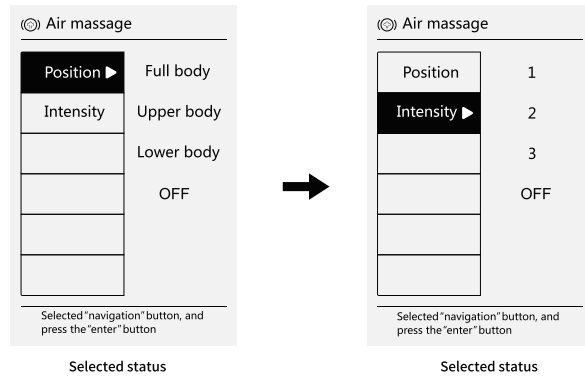

### 8. Additional functions

- Heating: it is designed with waist and leg heating function, adopts graphene as far-infrared source
- V-motion: leg swing stretch patented technology, kneading along the calf muscles can effectively relax the muscles.
- Roller: foot roller massage with 3 speed, scrap the plantar.
- Kneading: leg kneading patent, with 3 speed option.

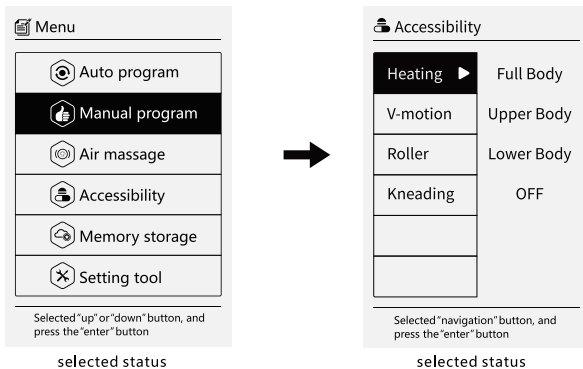

## Usage methods

### 9. Memory storage

- Enter menu interface by pressing 'Menu' button, choose memory storage function: M1, M2 and M3.
- Save: store current massage mode, massage methods, airbag mode and strength, calfcrest and backrest position...etc.
- Use: choose saved massage mode, massage method, airbag mode and strength, calfcrest and backrest position...etc.

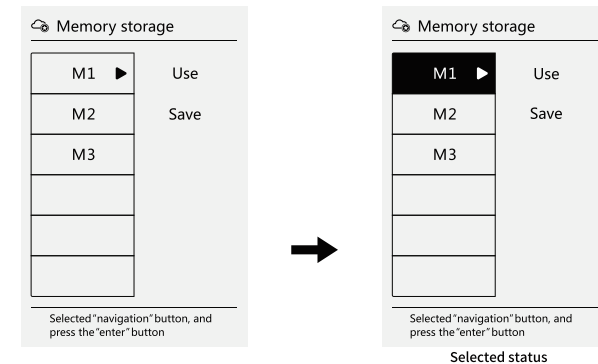

### 10. Setting tool

- Enter main menu interface by pressing 'Menu' button choose setting tool icon: timer, LED light, language, Bluetooth.
- There are 3 timing levels, 10 minutes, 20 minutes, 30 minutes.
- LED light: turn on and off LED light.
- Bluetooth: turn on cellphone Bluetooth and match massage chair(matching code 0000 or 1234), music can be played once matching is successful.
- Language: simplified Chinese, English, traditional Chinese.

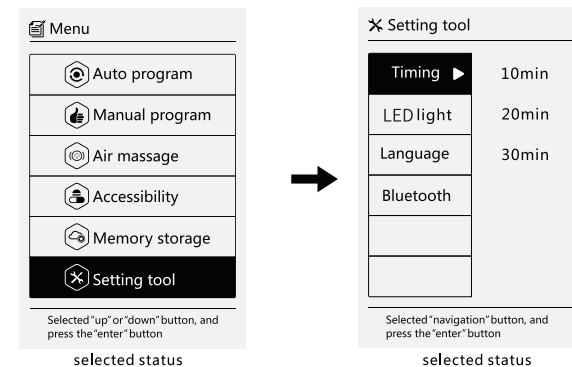

## Usage methods

### III、Voice control operation

- Awaken voice control function by speaking ‘Hi,what’s up’ when massage chair is turned on or under standby status.
- Once it is awakened, it will answer ‘I am here’, users can speak corresponding voice control words within 6 seconds, otherwise the voice control function will be turned off automatically and needs to be awakened again.
- Under noisy condition or when music is played, the awaken voice will not be sensitive, it can be done by pressing the voice control button on remote control. Press the button short to awaken it, shut it off if press more than 3 seconds, and the awakening of voice control under this circumstance can only be done by pressing the button.

Note: Please speak correct and slowly, follow below words

Voice control words		
Awakening words: “Hi,what’s up?” Answer:I am here		
NO.	Corresponding words	Answer words
1	Massage On	Answer: OK, Massage On
2	Massage OFF	Answer: OK, Massage OFF
3	Massage’ choice	Answer: OK, Massage’ choice
4	Easy-sleep	Answer: OK, Easy-sleep
5	Health Recharge	Answer: OK, Health Recharge
6	Pain Recharge	Answer: OK, Pain Recharge
7	Full Body Stratch	Answer: OK, Full Body Stratch
8	Neck & Shoulder	Answer: OK, Neck & Shoulder
9	Waist Care	Answer: OK, Waist Care
10	Hip Shaping	Answer: OK, Hip Shaping
11	Fixed Massage	Answer: OK, Fixed Massage
12	Change To Another Mode	Answer: OK, Change To Another Mode
13	Go a Little Down	Answer: OK, Little Down
14	Go a Little Up	Answer: OK, Little Up
15	Sit Up	Answer: OK, Sit Up
16	Recline Down	Answer: OK, Recline Down
17	Stop Adjustment	Answer: OK, Stop Adjustment

## Usage methods

### IV、Fast control button

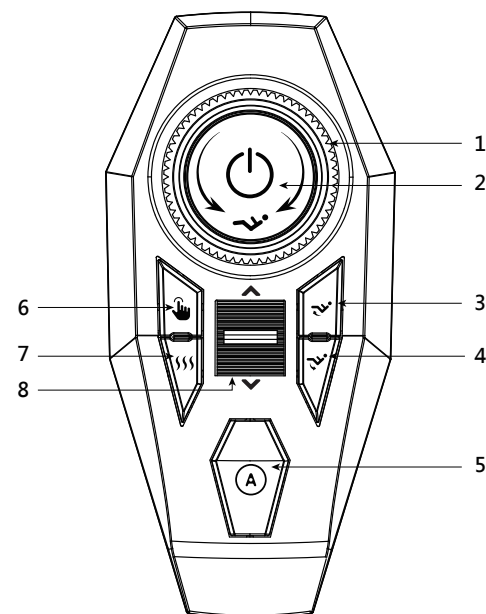

1. Knob switch: the backrest lies down with a clockwise rotation, reclines by counterclockwise rotation. When it reaches the maximum or minimum gear, it makes “DiDi” alerts. The knob makes a beep when it works.
2. Power switch: short press to pause massage /long press to turn on or off massage chair
3. Calfrest recline: lift up the calfrest slowly by pressing this button, it stops when finger loses.
4. Calfrest decline: lay down the calfrest slowly by pressing this button it stops when finger loses.
5. Auto program: press this button to switch the auto program, total 12 auto programs.
6. Manual program: press this button to switch the manual programs.
7. Heating: press this button to turn on or off heating function.
8. Massage position: the massage hand goes up while push this button forward, and goes down while pull back. It only can be adjusted on partial and fixed position massage under manual mode.

## Usage methods

### V、Turn off and stop massage

- Stop all massage functions by pressing 'On/Off' button during massage process, calfrest, backrest and massage hands return to original position. When timing out, all massage functions stop automatically, while calfrest and backrest position will not change.
- Shut-off power.

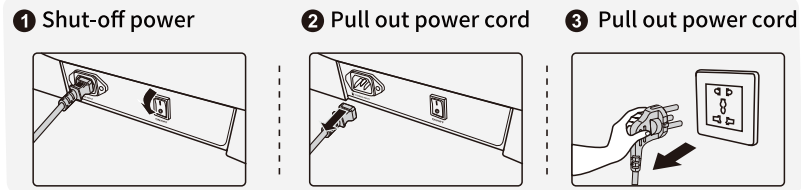

### VI、Method to move the product

- Move the backrest to highest position.
- Shut-off power and pull out the power cord.
- Lift up the front part and press down the back part, move the chair by caster.
- Once movement is done, put the chair to original position slowly.

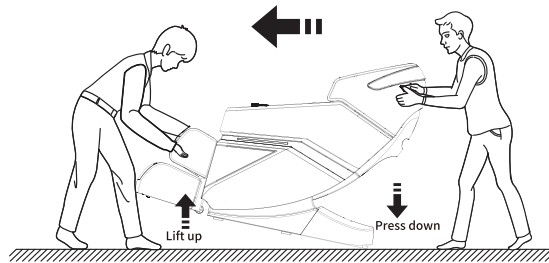

**Note: movement must be done when the power switch is turned off and power cord and remote wire is unplugged.**

## Usage methods

### VII、Specification

Name: Massage Chair

Model: HY-5082A

Rated voltage: 110V-120V-60Hz   
220v-240-50/60hz

Rated power: 170W

Safety design: Class I

Executive standard: GB4706.1-2005 GB4706.10-2008

### Maintenance and cleaning of product

1. Don't clean this product with corrosive cleanser such as diluent.
2. Don't iron the surface material.
3. Don't press, knock and scratch the massage chair.
4. Press the remote control button gently.
5. It is recommended to use no more than 30 minutes at one time.
6. Please pull out the plug immediately after usage.
7. Pull out the plug before cleaning. Don't touch the plug with wet hands, to avoid electric shock and injury.